

This resort-like hotel is located at the foot of Mt. Umyeonsan and Citizens' Grove in Yangjae-dong. It offers 252 guest rooms plus banquet halls, convention halls, a fitness center and a large theater. Featuring meeting rooms in a variety of sizes, this hotel is available for corporate training, seminars or workshops, family gatherings and banquets.

- Hotel Grade: 5 Star
- Total Area(m<sup>2</sup>): 105,000m<sup>2</sup>
- No. of Meeting Rooms: About 30
- No. of Guest Rooms: 252
- Year of Establishment: 1991
- From Incheon Int'l Airport: 60min. / 70.76km
- Subway Station: Line #3 Yangjae Station, New Bundang Line Yangjae Citizen's Forest Station

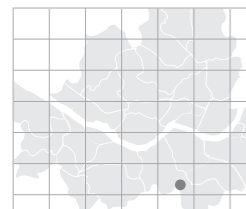

> Map: J-12



70 Baumoe-ro 12 gil, Seocho-gu, Seoul, 06769, Korea  
reservation@thek-hotel.co.kr  
Tel: 82-2-571-8100

Person in Charge\_Hwansu Kim  
Tel: 82-2-526-9389  
Fax: 82-2-571-4929  
thekms2633@hanmail.net

**Special Features** Grand Ballroom with a spacious area that holds a capacity of 2,000 people, it offers states-of-the-art facilities and high-quality service to host successful events like international events, fashion shows and seminars.

**Major Events** ★IEEE NetSoft 2016 – Jun. 2016 ★The International School and Conference on Network Science 2016 – Jun. 2016 ★The 11th International Symposium Macrocyclic Supramolecular Chemistry – Jul. 2016 ★The 4th Asian EMS Conference – Aug. 2016 ★Asia Spine 2016 – Sep. 2016 ★2017 Neobiotech World Symposium – Sep. 2017 ★12th Asian Pacific Society of Periodontology Meeting – Sep. 2017 ★APEC Women Business Leaders Forum – Nov. 2017

## MEETING & BANQUET FACILITIES

Name of Hall	Location	Size (m <sup>2</sup> )	Theater	Classroom	Cocktail	Banquet	Height (m)
Geomungo (A+B+C)	3F	1,178	1,300	800	1,000	700	3.8
Geomungo (A,B)	3F	330	250	200	200	120	3.8
Geomungo (C)	3F	495	300	270	200	150	3.8
Gayageum (A+B)	2F	785.4	600	430	500	350	3.3
Gayageum (A,B)	2F	387	250	200	200	120	3.3
Bipa	3F	165	100	80	100	70	2.4
Daegeum	3F	165	80	70	80	60	3.1
Haegeum (A)	3F	141.9	50	36	50	40	3.1
Haegeum (B)	3F	184.8	70	48	70	50	-
Small Conference Room	2F	39	24	20	-	15	2.0
Hankang	1F (Annex)	285	200	150	200	120	3.2
Geumkang (A)	2F (Annex)	286	200	150	200	120	3.2
Geumkang (B)	2F (Annex)	43	40	30	-	15(U shape)	3.2
Dongkang (A,B)	3F (Annex)	141	100	70	70	60	2.5
Dongkang (C,D)	3F (Annex)	43	40	30	-	15(U shape)	2.5
Namkang (A,B)	B1F (Annex)	69	50	36	-	20	2.5
Namkang (C)	B1F (Annex)	56	40	30	-	15	2.5
Grand Ballroom (A+B)	2F (Convention Center)	1,893	1,800	1,500	2,000	1,100	7.5
Grand Ballroom (A)	2F (Convention Center)	705	550	400	500	300	7.5
Grand Ballroom (B)	2F (Convention Center)	1,188	900	800	1,000	600	7.5
Crystal Ballroom (A+B)	3F (Convention Center)	608	-	350	300	240	5
Crystal Ballroom (A)	3F (Convention Center)	342	-	120	110	90	5
Crystal Ballroom (B)	3F (Convention Center)	266	-	180	140	110	5
Four Seasons	1F (Convention Center)	900	800	-	1,000	-	5

## 3F

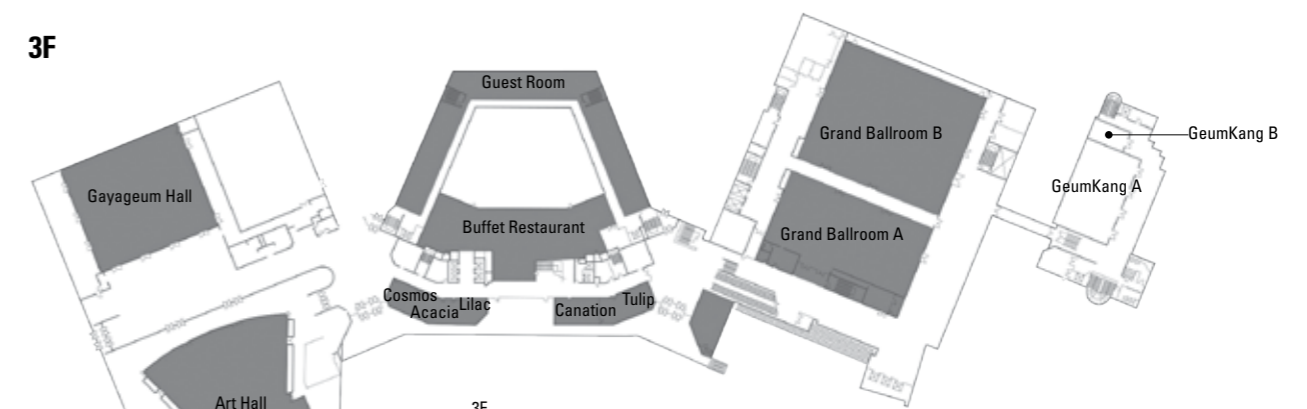

3F

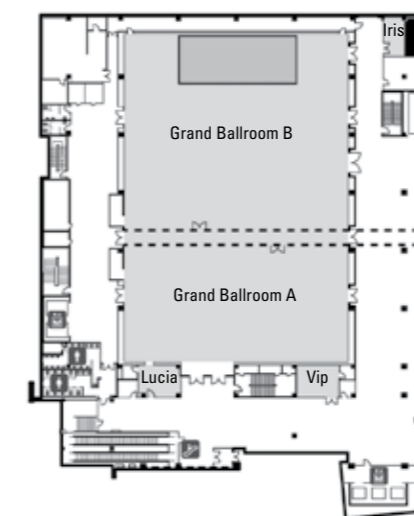

## GUEST ROOMS

Room Type	Rooms
Royal Suite A	1
Royal Suite B	1
Western Suite	9
Korean Suite	4
Business Double	16
Business Twin	12
Double Twin	173
Korean Ondol (Heated Floor)	14
Standard Twin	14
Meeting Room A	2
Meeting Room B	4
Meeting Room C	2
<b>Total</b>	<b>252</b>

\* Average Rates (Ordinary Rooms): KRW 140,000 - 160,000

## Nearby Attractions

- **Entertainment:** Seoul Arts Center, KEPCO Art Center
- **Parks:** Yangjaecheon (Stream), Seolleung Park